

Glue & Screw All Blocking and
Nailing Strip to Soffit Material and
into wall framing through
Stucco/Siding

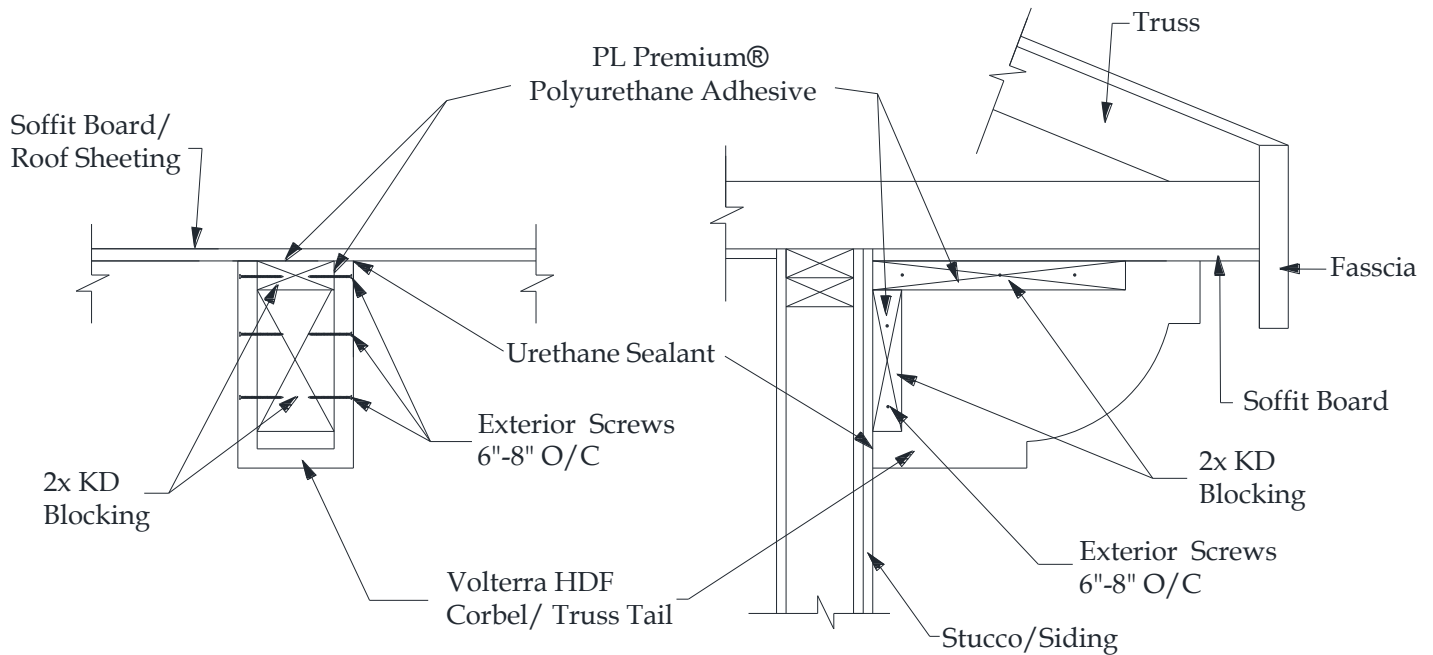

Sectional View

Front

Sectional View

Side

Sept. 2016

HDF Corbel/Truss Tail must be screwed, glued to blocking and blocking must be mechanically fastened to structural members - check local codes before installing HDF Corbels or Truss Tails. Apply Urethane sealant around entire perimeter of Corbel/Truss Tail.