

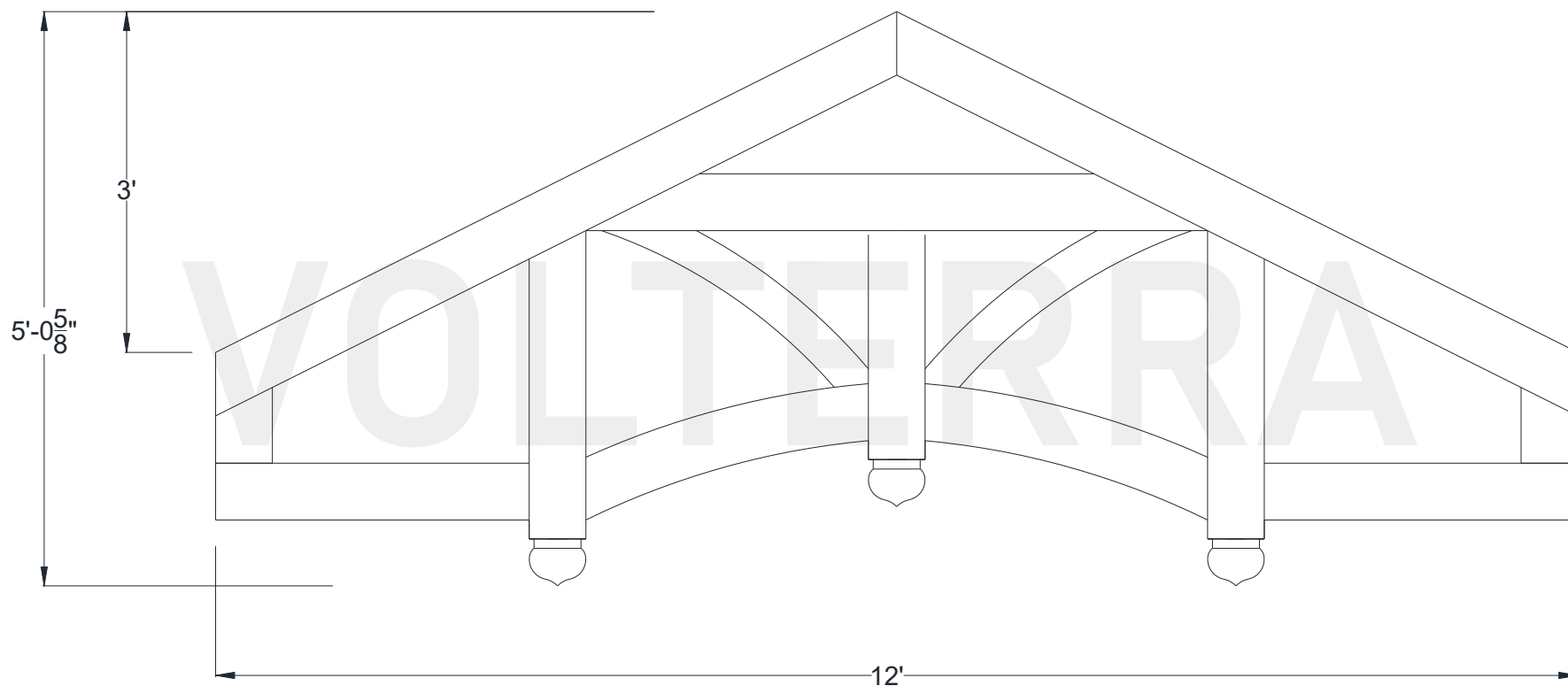

## Wasatch Hammered Truss

144" Width

Shown: 6/12 Pitch



Volterra Architectural Products LLC – 1902 North 22nd Avenue – Phoenix , AZ 85009 – 602.258.7373

[www.volterraproducts.com](http://www.volterraproducts.com)

# Wasatch Hammered Truss

## 144" Width

### Dimension Sheet

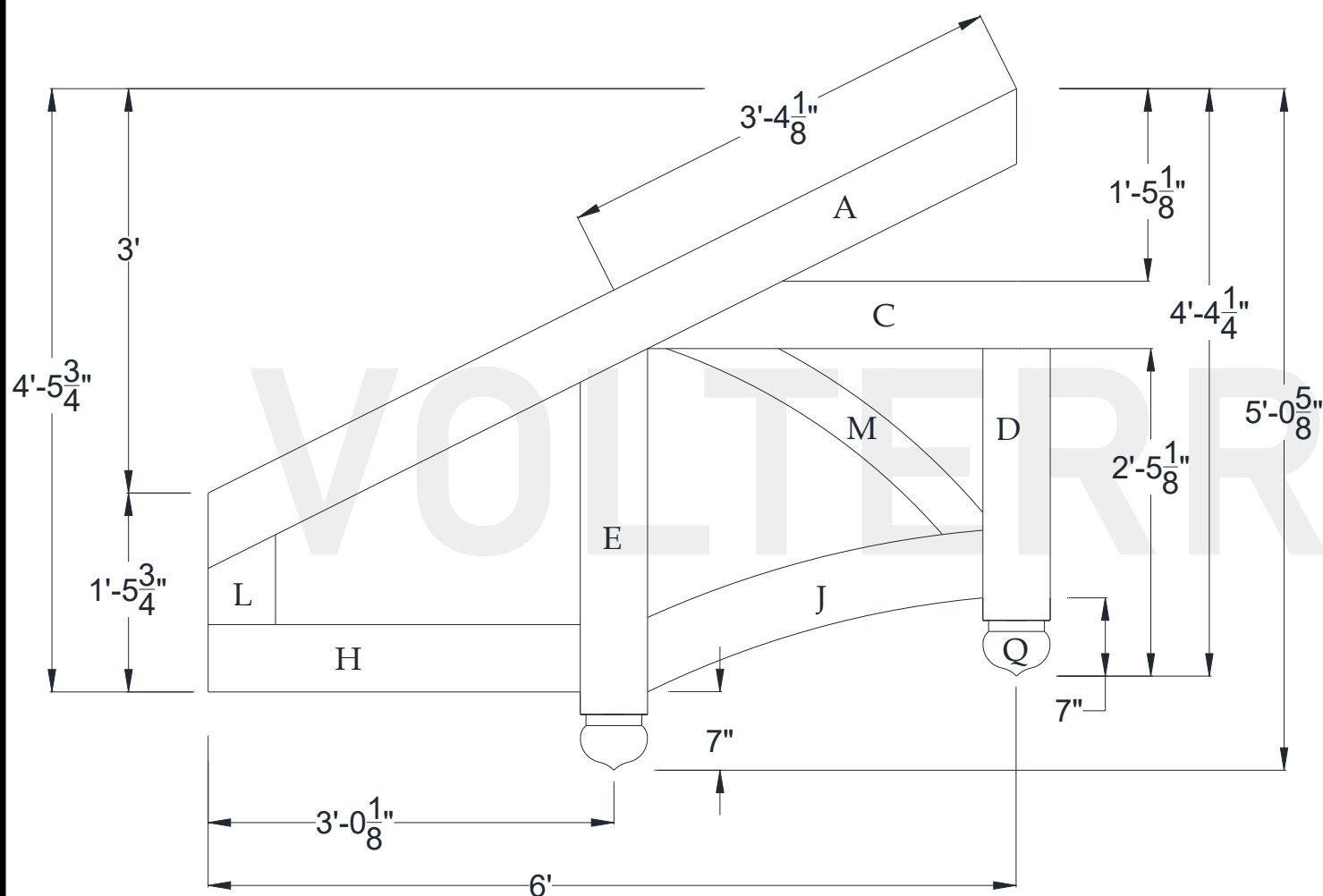

#### Specifications

|                        |        |
|------------------------|--------|
| Pitch:                 | 6/12   |
| A) Rafter/Top Chord:   | 6"x 6" |
| B) Bottom/Tie Chord:   | N/A    |
| C) Upper/Tie Chord:    | 6"x 6" |
| D) King Post:          | 6"x 6" |
| E) Queen Post:         | 6"x 6" |
| F) Jack Post:          | N/A    |
| G) Hammer Beam Top:    | N/A    |
| H) Hammer Beam Btm:    | 6"x 6" |
| I) Collar Brace Upper: | N/A    |
| J) Collar Brace Lower: | 6"x 6" |
| K) Hammer Brace:       | N/A    |
| L) Wall Post:          | N/A    |
| M) Web 1:              | 3"x 3" |
| N) Web 2:              | N/A    |
| O) Web 3:              | N/A    |
| P) Flying Buttress:    | N/A    |
| Q) Newel End:          | AC     |



## Wasatch Truss Recommended Interior Installation Procedures

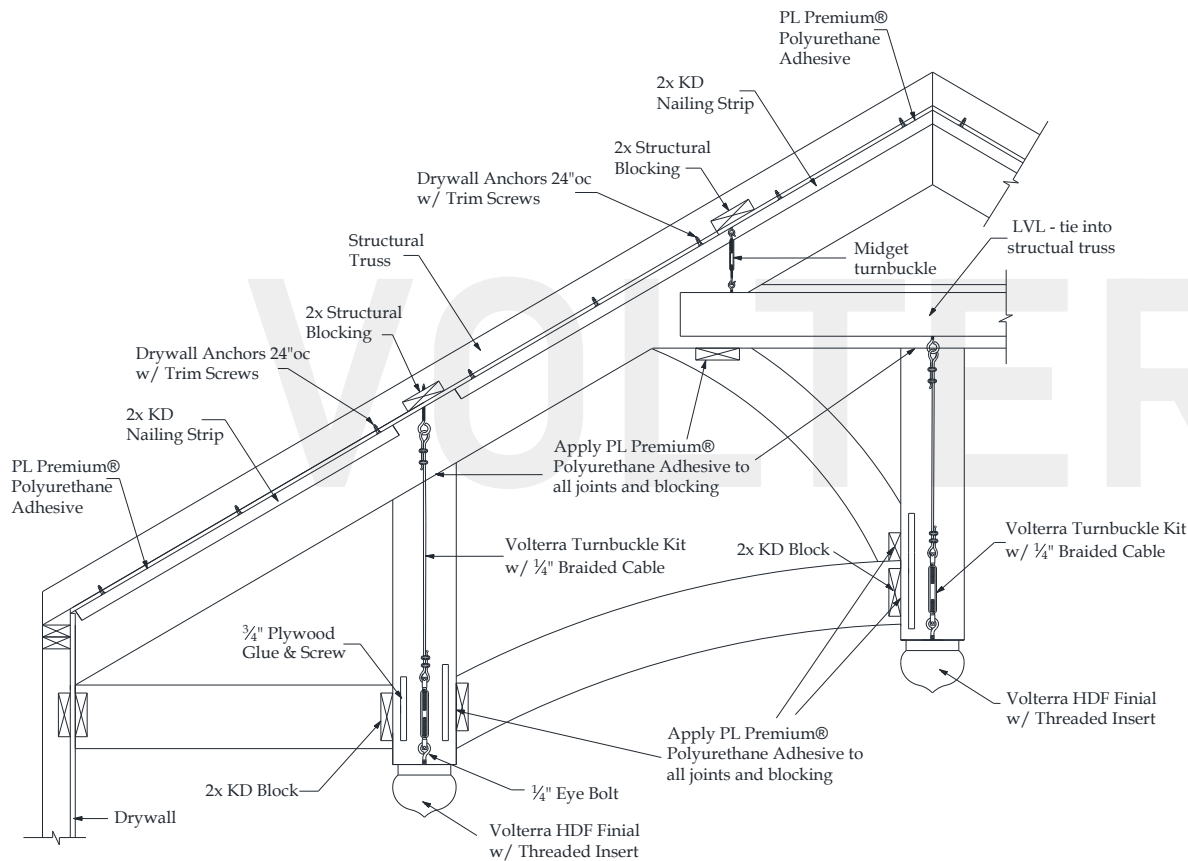

**A:** Layout beams and chalk lines to the inside of rafter beam.

**B:** Measure down ridge and screw in threaded eye bolts into structural blocking at all points.

**C:** Place KD nailing strip on chalk line and pre-drill  $\frac{1}{8}$ " holes 24" on center through strip and into drywall. Install drywall anchors into predrilled holes. Apply  $\frac{1}{4}$ " bead of PL adhesive to top of nailing strip and install using deck screws.

**D:** Measure, cut and dry fit rafter beam then pull beam down. Apply PL adhesive to sides of nailing strips. Install rafter beam and use trim screws to secure 24" on center.

**E:** Cut 3"-6" diameter round hole for queen post turnbuckle. Using a level mark and cut 6" tall x 4"-6" wide square hole for LVL - bottom side of rafter beam.

**F:** Install LVL (screw eyelets in prior to installation) and then upper tie chord. 2x blocking (furring) should be used inside top chord for a tight fit. Cut 3"-4" round hole for turnbuckle on the bottom side of top chord for King Post installation.

**F:** Measure correct length and cut braided cable and install turnbuckle kit. Glue and screw off  $\frac{3}{4}$ " screw plate to inside of king and queen post for connection of hammer and collar brace. Stain raw foam on king/queen post and loose side. Install king/queen posts and their 4th side.

**G:** Glue and screw 2x blocks for both braces. Measure and cut both braces. Dry fit first. Apply PL adhesive to contact areas. Install using trim screws.

**H:** Measure, cut and dry fit web beam. Glue and toe screw in place. Patch holes and touch up HDF if necessary.

Volterra Architectural Products LLC – 1902 North 22nd Avenue – Phoenix , AZ 85009 – 602.258.7373

[www.volterraproducts.com](http://www.volterraproducts.com)