

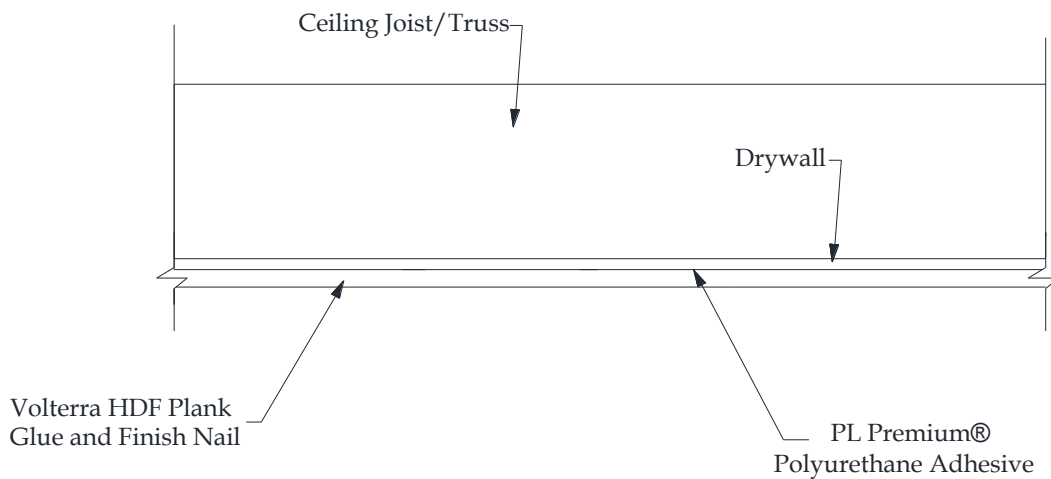

Installation Recommendation HDF Plank To Interior Drywall



Note: Apply a ¼" bead of PL Polyurethan Construction Adhesive to back of HDF Planks 3" On Center and tack off with 16 gauge finish nails @ 2-4 per square foot.

Category: Plank • Texture: All • Product: HDF - High Density Foam

Volterra Architectural Products LLC-1902 North 22nd Avenue, Phoenix, AZ 85009
www.voltterraproducts.com